

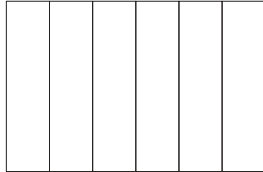

ICONIC FASCIA WALL COLLECTION

DESCRIPTION: Fascia Panel & Corner **TEXTURE:** Klean-Bloc Natural Stone

PALLET OVERVIEW - PANELS



PALLET OVERVIEW - CORNERS

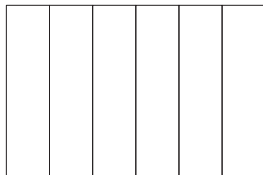

Specifications per pallet		Imperial	Metric
FASCIA	Cubing	42 units	42 units
		44.75 ft ²	4.16 m ²
		90.94 lin. ft	27.72 lin. m
	Approx. Weight	1 250 lbs	567 kg
	Number of rows	7	
	Coverage per row	6.39 ft ²	0.60 m ²
	Linear coverage per row	13.03 lin. ft	3.96 lin. m

Unit dimensions		in	mm	Units/pallet
A	Height	5 7/8	150	42 units
	Depth	2 3/4	70	
	Length	26	660	



COMPATIBLE CAPS

See page 135 for product compatibility.

Klean-Bloc technology
See page 14.

NOTES

See page 136 to 151 for more technical information.

Fascia Panels require single-sided structural blocks (retaining wall application) or double-sided structural blocks (freestanding walls). Sold Separately.

The top of Fascia Panels shall not be left exposed, they must be stabilized with a structural block on top or glued to the cap.

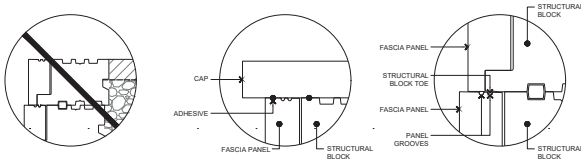

Specifications per pallet		Imperial	Metric
CORNER	Cubing	24 units	24 units
	Approx. Weight	700 lbs	318 kg
	Number of rows	4	
	Pillar height	35 1/16 in	900 mm

Unit dimensions		in	mm	Units/pallet
A LEFT UNIT	Height	5 7/8	150	12 units
	Depth	2 3/4	70	
	Length	23 1/4	590	

Unit dimensions		in	mm	Units/pallet
B RIGHT UNIT	Height	5 7/8	150	12 units
	Depth	2 3/4	70	
	Length	23 1/4	590	



FASCIA WALL COLLECTION

DESCRIPTION: Base and Structural block single-sided & double-sided **TEXTURE:** Smooth

PALLET OVERVIEW - SINGLE-SIDED

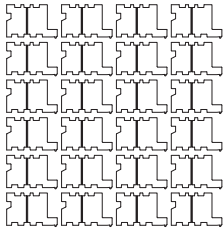

PALLET OVERVIEW - DOUBLE-SIDED

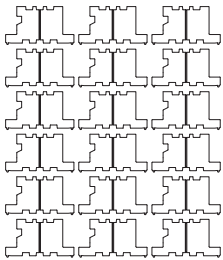

PALLET OVERVIEW - BASE

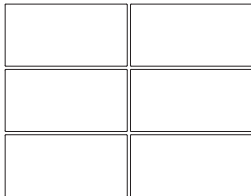

COMPATIBLE CAPS

See page 135 for product compatibility.

NOTES

See page 136 to 151 for more technical information.

The top of Fascia Panels shall not be left exposed, they must be stabilized with a structural block on top or glued to the cap.

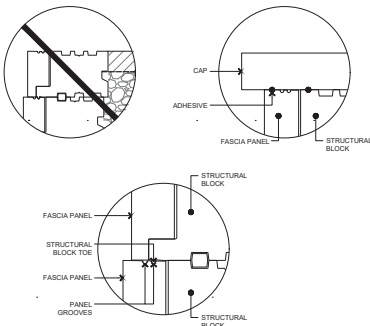

Specifications per pallet		Imperial	Metric
SINGLE-SIDED		96 units	96 units
	Cubing	31.00 ft ²	2.88 m ²
		62.99 lin. ft	19.20 lin. m
	Approx. Weight	2 612 lbs	1 185 kg
	Number of rows	4	
	Coverage per row	7.75 ft ²	0.72 m ²
Linear coverage per row	15.75 lin. ft	4.80 lin. m	



Unit dimensions		in	mm	Units/pallet
Height	5 7/8	150	96 units	
Depth	9 1/4	235		
Length	7 7/8	200		



Specifications per pallet		Imperial	Metric
DOUBLE-SIDED		72 units	72 units
	Cubing	23.25 ft ²	2.16 m ²
		47.24 lin. ft	14.40 lin. m
	Approx. Weight	2 138 lbs	970 kg
	Number of rows	4	
	Coverage per row	5.81 ft ²	0.54 m ²
Linear coverage per row	11.81 lin. ft	3.60 lin. m	



Unit dimensions		in	mm	Units/pallet
Height	5 7/8	150	72 units	
Depth	11 1/16	281		
Length	7 7/8	200		

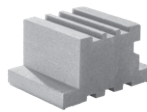

Specifications per pallet		Imperial	Metric
BASE		66 units	66 units
	Cubing	25.58 ft ²	2.38 m ²
		129.92 lin. ft	39.60 lin. m
	Approx. Weight	3 701 lbs	1 679 kg
	Number of rows	11	
	Coverage per row	2.33 ft ²	0.22 m ²
Linear coverage per row	11.81 lin. ft	3.60 lin. m	



Unit dimensions		in	mm	Units/pallet
Height	2 3/8	60	66 units	
Depth	12	305		
Length	23 5/8	600		



INSTALLATION GUIDE

FREESTANDING WALL

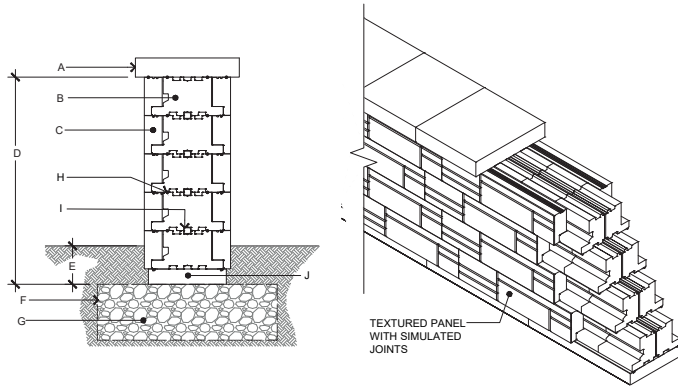

- A. TECHO-BLOC CAP UNIT SECURED TO CORE AND PANEL BELOW WITH FLEXLOCK ADHESIVE
- B. STRUCTURAL BLOCK DOUBLE-SIDED UNIT
- C. PANEL UNIT
- D. 29 1/2" (750 mm) MAX.
- E. EMBEDMENT DEPTH 6" (150 mm) MIN.
- F. GEOTEXTILE
- G. COMPACTED GRANULAR BASE 6" (150 mm) MIN. THICKNESS ACCORDING TO PROJECT SPECIFICATIONS
- H. FLEXLOCK ADHESIVE
- I. HDPE HORIZONTAL KEY
- J. BASE UNIT

FREESTANDING WALL - 90° CORNER

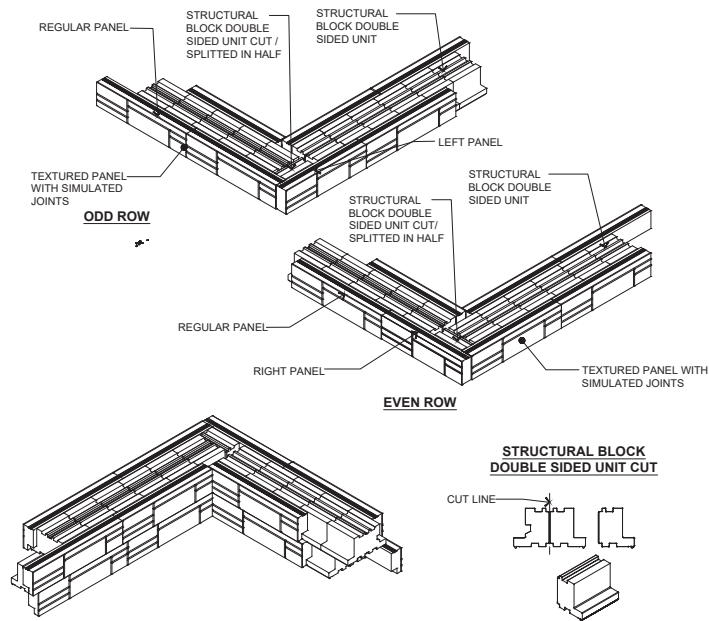

1. ALTERNATE ODD AND EVEN ROWS.
2. STAGGER STRUCTURAL BLOCKS JOINTS FROM ONE ROW TO THE NEXT.
3. GLUE ALL STRUCTURAL BLOCKS AT EACH ROW WITH FLEXLOCK ADHESIVE.
4. APPLY FLEXLOCK ADHESIVE ON TOP OF UPPERMOST PANEL UNITS TO FIX CAP UNITS.
5. STRUCTURAL BLOCK DOUBLE SIDED UNIT CUT / SPLITTED IN HALF MUST ALWAYS BE PRESENT AT THE CORNER OF THE WALL.

NOTE:

The top of Fascia Panels shall not be left exposed, they must be stabilized with a structural block on top or glued to the cap.

GRAVITY RETAINING WALL

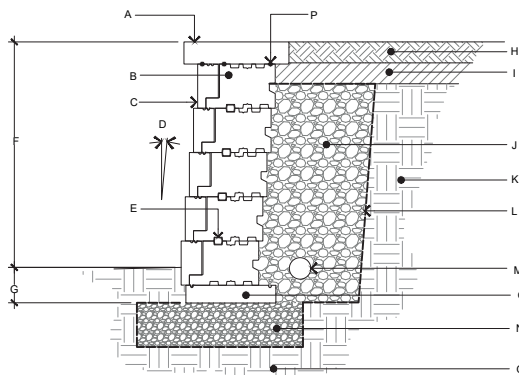

- A. TECHO-BLOC CAP UNIT SECURED TO UNIT BELOW WITH FLEXLOCK ADHESIVE
- B. STRUCTURAL BLOCK SINGLE SIDED UNIT
- C. PANEL UNIT
- D. WALL INCLINATION (5.3°)
- E. HDPE HORIZONTAL KEY
- F. EXPOSED HEIGHT
- G. EMBEDMENT DEPTH
- H. TOP SOIL
- I. LOW PERMEABILITY SOIL
- J. 3/4" (20 mm) CLEAN STONE 14" (350mm) THICK MIN.
- K. RETAINED SOIL
- L. GEOTEXTILE
- M. PERFORATED DRAIN
- N. LEVELING PAD
- O. FOUNDATION SOIL
- P. FLEXLOCK ADHESIVE
- Q. BASE UNIT

PLEASE REFER TO P.4 FOR THE CORRECT USE AND LIMITATIONS OF PROVIDED TECHNICAL INFORMATION.

INSTALLATION GUIDE

FREESTANDING END OF A STRAIGHT WALL (OPTION 1)

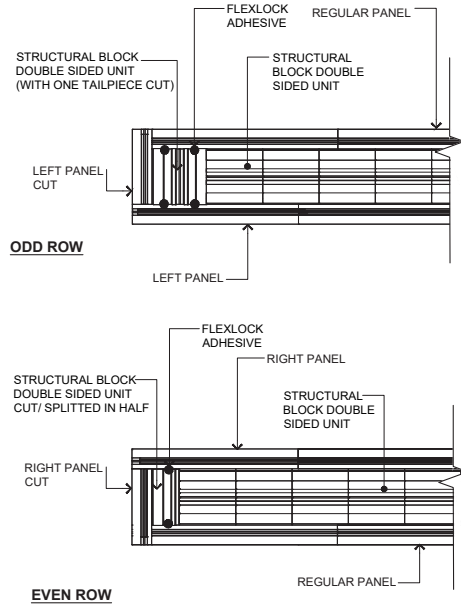

NOTES:

1. ALTERNATE ODD AND EVEN ROWS.
2. STAGGER STRUCTURAL BLOCKS JOINTS FROM ONE ROW TO THE NEXT.
3. GLUE ALL STRUCTURAL BLOCKS AT EACH ROW WITH FLEXLOCK ADHESIVE.
4. APPLY FLEXLOCK ADHESIVE ON TOP OF UPPERMOST PANEL UNITS TO FIX CAP UNITS.

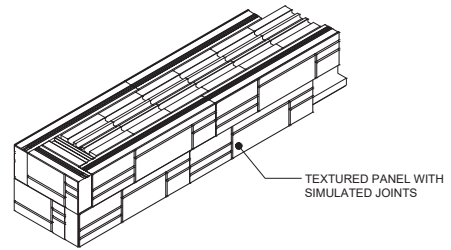

NOTE:

The top of Fascia Panels shall not be left exposed, they must be stabilized with a structural block on top or glued to the cap.

FREESTANDING END OF A STRAIGHT WALL (OPTION 2)

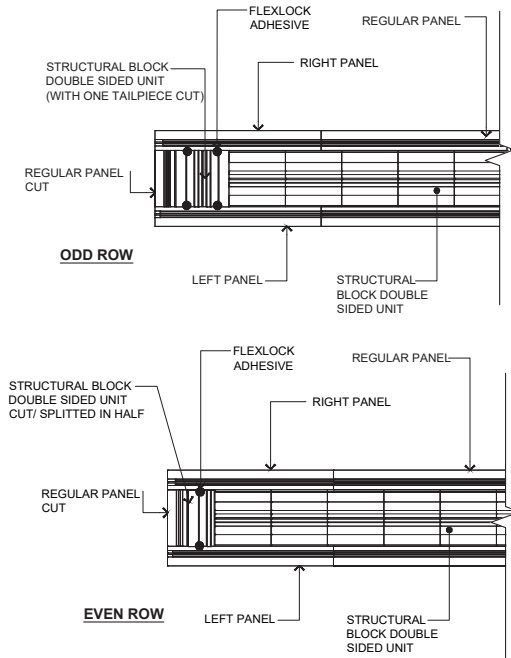

NOTES:

1. ALTERNATE ODD AND EVEN ROWS.
2. STAGGER STRUCTURAL BLOCKS JOINTS FROM ONE ROW TO THE NEXT.
3. GLUE ALL STRUCTURAL BLOCKS AT EACH ROW WITH FLEXLOCK ADHESIVE.
4. APPLY FLEXLOCK ADHESIVE ON TOP OF UPPERMOST PANEL UNITS TO FIX CAP UNITS.

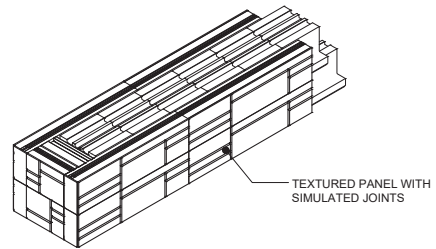

INSTALLATION GUIDE

PILLARS - FASCIA WALL COLLECTION

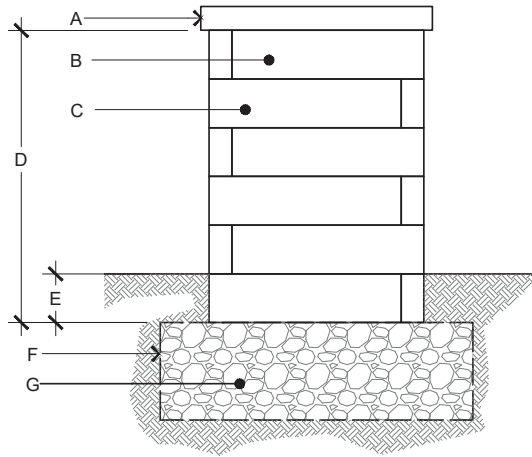

STRUCTURAL BLOCK SINGLE SIDED UNIT CUT / SPLITTED IN HALF

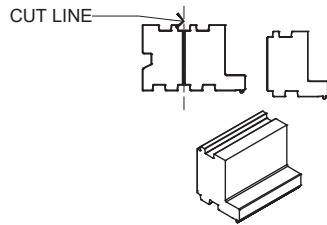

- A.** PILLAR CAP UNIT SECURED TO CORE AND PANEL BELOW WITH FLEXLOCK ADHESIVE
- B.** RIGHT PANEL
- C.** LEFT PANEL
- D.** 35 7/16" (900 mm) MAX HEIGHT
- E.** EMBEDMENT DEPTH 6" (150 mm) MIN.
- F.** GEOTEXTILE
- G.** COMPACTED GRANULAR BASE 6" (150 mm) MIN. THICKNESS ACCORDING TO PROJECT SPECIFICATIONS.

NOTE:

The top of Fascia Panels shall not be left exposed, they must be stabilized with a structural block on top or glued to the cap

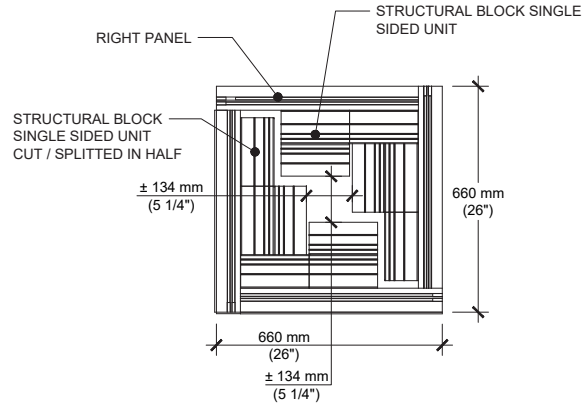

ODD ROW

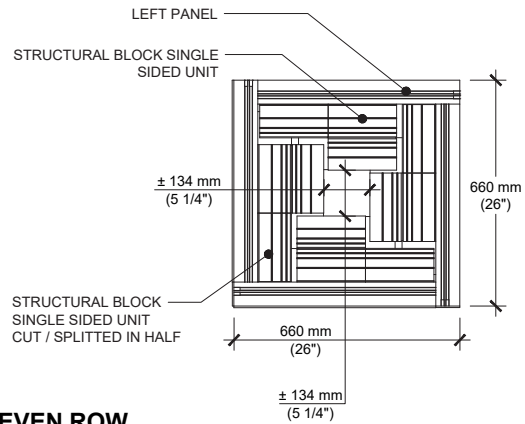

EVEN ROW

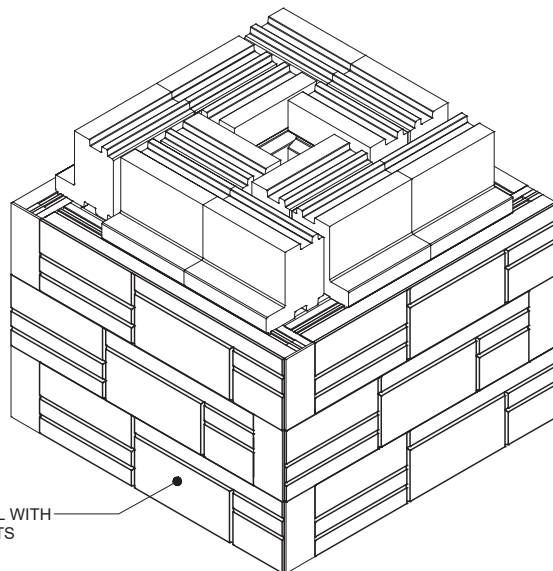

TEXTURED PANEL WITH SIMULATED JOINTS

For all possible combinations of pillars and caps, please refer to the correspondence table on page 135

INSTALLATION GUIDE

STEPS - FASCIA WALL COLLECTION

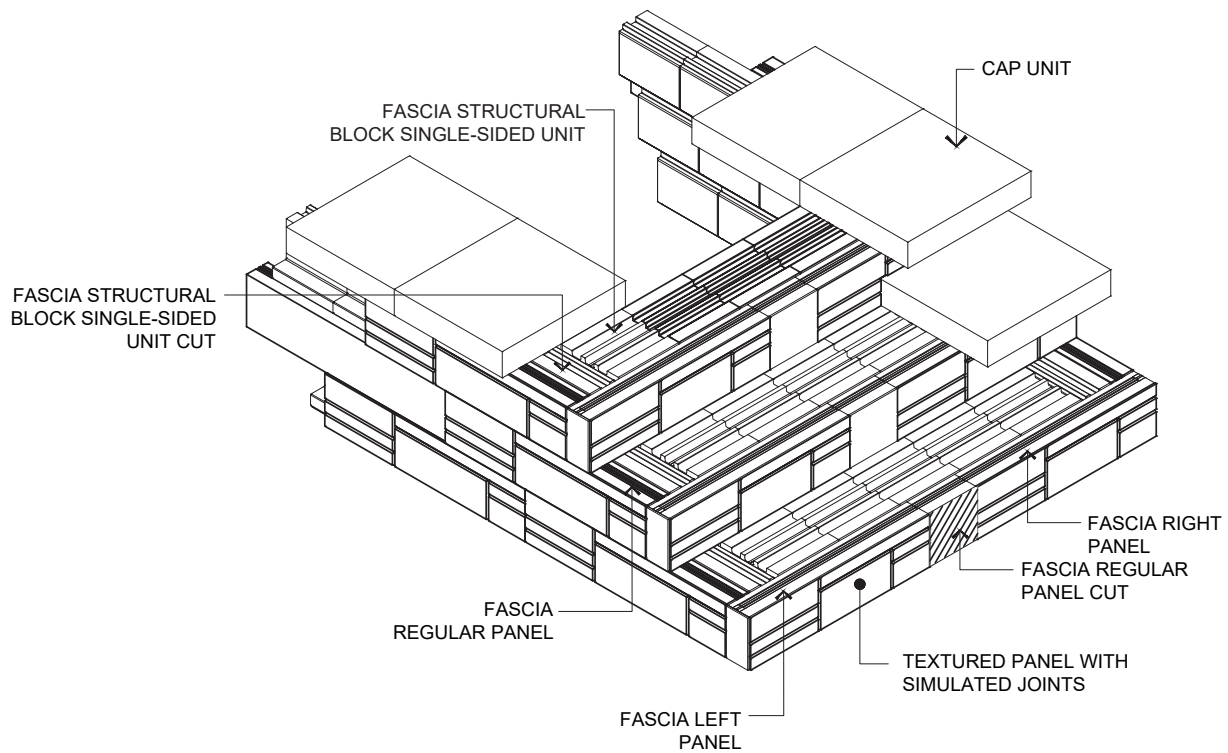
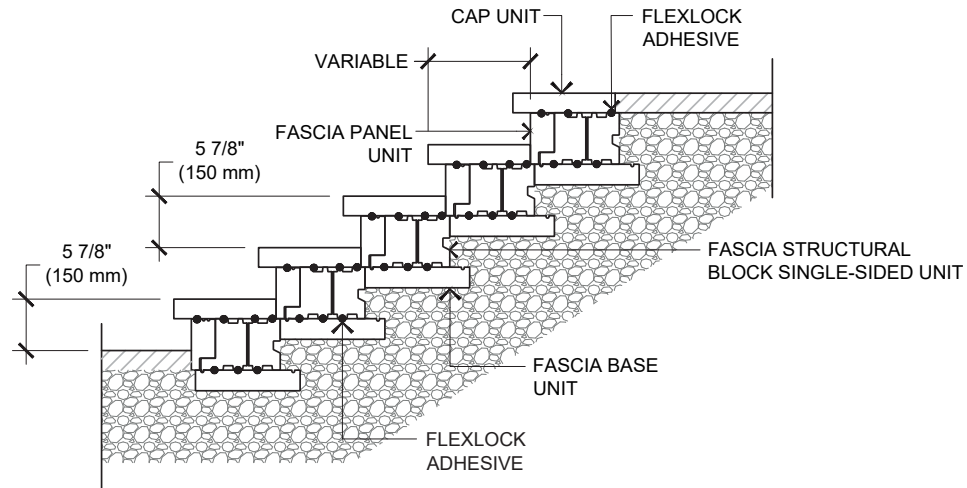

NOTE:

The top of Fascia Panels shall not be left exposed, they must be stabilized with a structural block on top or glued to the cap

Check with your local Building Codes to determine any restrictions or guidelines regarding the dimensions of steps (including riser height and step tread) as well as handrail specifications.

PLEASE REFER TO P.4 FOR THE CORRECT USE AND LIMITATIONS OF PROVIDED TECHNICAL INFORMATION.