

WeatherTRAK® FlowLink™

Tech Sheet

Introduce Flow Management to Existing Irrigation Systems



The WeatherTRAK FlowLink solution enables a Flow Sensor and Master Valve to be installed on sites where additional wires are not available. With FlowLink technology you're able to share an existing field wire back to the WeatherTRAK controller, bringing flow management to sites that were once thought impossible.

Adding Flow Sensing and Mainline Control to Your Landscape Irrigation System Has Never Been Easier

A Simple Solution To These Common Obstacles

No Extra Wires are Available

Only One Extra Wire is Available

Trenching New Wires to Controller is Not Possible

Trenching New Wire to Controller is Possible, but Not Preferred

Easy to Install, For any Situation

- Complete flow and master valve communication over existing field valve wire
- FlowLink XT = Add a flow sensor using an existing master valve's field wire
- FlowLink XT+ = Add a flow sensor & master valve using an existing station valve's field wire

Robust Flow Monitoring Capability for Protection from Catastrophic Events

- Monitoring five flow functions independently with flow readings and master valve control
- Ability to test for catastrophic mainline breaks
- Intelligent master valve management protects assets while avoiding unnecessary disruptions

Intelligent Flow Analysis for True Leak Detection

- Learned flow and station-level flow management for accurate alerts
- Flexible global settings and ability to override individual settings—fine tune your monitoring
- Leak detection engineered to find true leaks

Full Flow Visibility & Easy Reporting

- Browser-viewable real-time system flow rate and operating stations
- Flow, runtime data and estimated usage available at anytime
- Flow reports for single or multiple controllers across a customized date range

EXAMPLE

- 1 Install FlowLink-FXT in valve box with flow sensor
- 2 Connect FlowLink-FXT "Flow" and "Master" wires to the flow sensor and master valve
- 3 Locate the nearest existing 14AWG station wire path leading back to controller. Connect FlowLink-EXT into the closest existing station valve's wire. *This can be done anywhere along the wire's path to the controller.*
- 4 Install FlowLink-EXT in valve box at connection
- 5 Trench new wire between FlowLink-FXT and FlowLink-EXT and connect the two
- 6 Install FlowLink-CT module next to controller and make connections as instructed

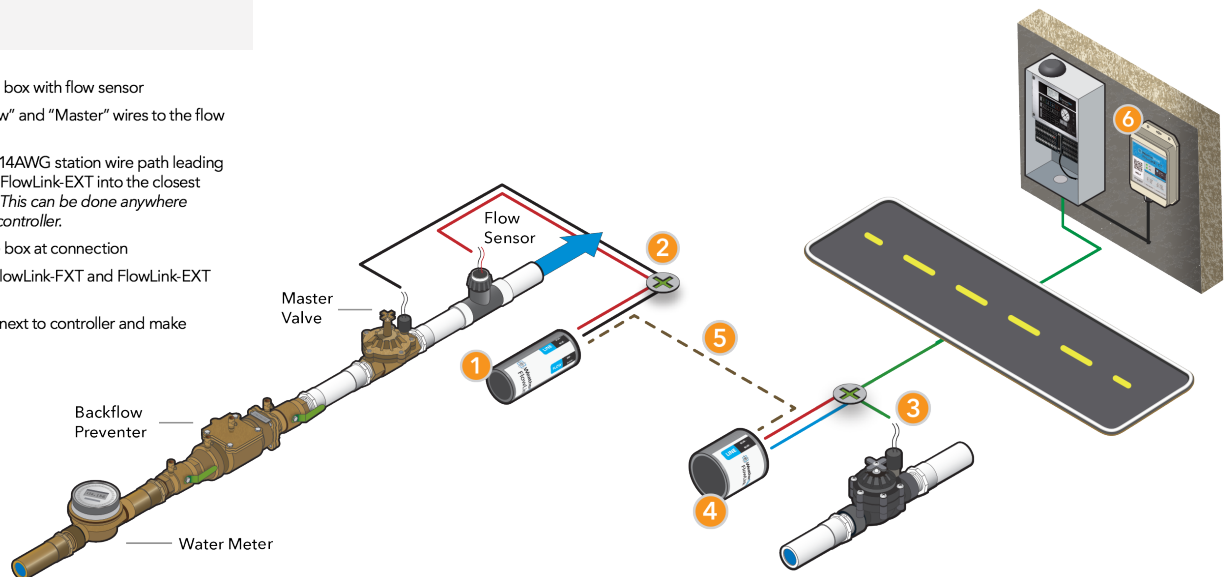

Learn more online at HydroPoint.com/Flow or call 1 (800) 362-8774 to schedule a demo.



WeatherTRAK® FlowLink™

Models and Specifications

Operational Range

Up to 4000ft from Controller to Field Transceiver (FXT or EXT)
Up to 170ft from FlowLink-EXT to solenoid

Electrical

Controller Transceiver (CT)

Station: 24VAC
Master Valve: 24VAC

Field Transceiver (FXT)

Station: 24VAC valves up to 600mA holding current
Master Valve: 24VAC valves up to 900mA holding current
Flow Sensor: loop current 6.5mA, - 0-400Hz

Extended Field Transceiver (EXT)

Station: 24VAC valves up to 600mA holding current

Communication

Operates over existing standard irrigation station wire
Compatible with the grounded valve common
Flow Rate Update: 10 seconds

Power

Controller Transceiver: 24 VAC from WeatherTRAK controller auxiliary power port
Field Transceivers: Powered remotely from Controller Transceiver

Environmental

Operating Temperature: -5C to 60C
Storage : -10C to 70C
Humidity: Controller Transceiver – 5% to 95% RH non-condensing
Field Transceivers: operate submerged under water

Controller Compatibility

WeatherTRAK ET Pro2, ET Pro2 Smart Water Manager, ET Pro3,
OptiFlow® XRand LC Controllers

Flow Sensor Compatibility

Data Industrial 228 series
WeatherTRAK Flow3 and FlowHD
CST flow sensor models

Shipping Package

Size: 12" x 9" x 3"
Weight: 3.5lb.



(CT)
Controller
Transceiver



(FXT)
Field
Transceiver



(EXT)
Extended Field
Transceiver

MODEL	PRODUCT DESCRIPTION	INCLUDES
WTFL - XT	Provides Flow Sensor input and master valve control using a spare unused field wire	FlowLink-CT FlowLink-FXT
WTFL - XT+	Provides Flow Sensor input and master valve control via an existing station field wire	FlowLink-CT FlowLink-FXT FlowLink-EXT

WeatherTRAK® Central™ Flow Features

General Flow Monitoring

- Multi-user access via secure login with access levels
- Monitoring five flow functions independently from one another: controller high flow, also known as catastrophic mainline break failure; station high flow; station no flow; leak detection; extended leak management
- User defined threshold flow values for each function independently
- User defined delay time from 1-6 minutes in 1-minute increments
- Flow threshold in 1 GPM increments up to 35 GPM and 5 GPM increments up to 995 GPM
- Instant remote shut-off / event pause
- Smart alert and email notification
- Alerts dashboard and detail with drill-down interface

Mainline Break Management

- Ability to monitor, fault and turn off all running stations and test to determine true mainline breaks
- Support for normally open and normally closed master valves

Learned Flow

- User can configure any stations to be learned
- Learned flow operation information stored
- Historical values available in the controller change history tracking report

Station Flow Management

- Station high flow threshold can be set independently by user, or globally as a % above learned flow rates
- User override of any individual station assigned flow rates or station high flow thresholds
- Automatic fault of currently running stations when high flow exceeded or below no flow rate threshold
- Scheduled irrigation stops when 3 stations in a row have a no flow alert
- Any station is excludable from station no flow monitoring

Leak Detection

- Leak detection notification indicates when station is not running scheduled or manual irrigation, and the system flow rate exceeds the leak threshold
- Extended leak management enables lower leak detection thresholds while eliminating false alarms

Flow Operating Status

- Viewable real-time actual system flow rate and operating stations
- Includes manual operating stations as if the user was in front of the controller

Flow Reporting

- Settings change history – station, program, and flow specific
- Actual and estimated usage by site, controller, and station
- Automatic daily or on demand upload of flow and runtime data to WeatherTRAK Central™
- Flow reports for single or multiple controllers across a customized date range
- Categorize usage by scheduled, manual and other irrigation to quickly determine the impact of manual irrigation or other unauthorized usage

Learn more online at HydroPoint.com/Flow or call 1 (800) 362-8774 to schedule a demo.

