

# LESCO

# Spray Gun

LESCO #007433  
LESCO Spray Gun w/o Nozzle

---

## Maintenance Instructions and Parts List

007433 LESCO GREEN GUN (No Nozzle)  
018104 Nozzle, 1.5 GPM (Blue)  
009510 Nozzle, 2 GPM (Yellow)  
007668 Nozzle, 3 GPM (Green)  
007655 Nozzle, 4 GPM (White)

(Note: Although the gun body will withstand pressures up to 400 PSI,  
do not exceed an operating nozzle pressure of 60 PSI.)

# MAINTENANCE INSTRUCTIONS

## GENERAL:

1. Before use, soak the gun in clean water overnight. Snap the trigger several times to properly seat the internal assembly into the valve seat.
2. After use, the gun should be removed from the sprayer hose and immersed in clean water where it should soak until the next use.
3. To remove dried material, soak the gun and nozzle in clean water.
4. Do not oil the gun. Oil attracts dirt which is abrasive and will wear working parts.
5. Year-end storage: Remove the nozzle from the front and the hose fitting from the back of the gun. Wash the gun and nozzle in a sink or bucket filled with soapy water. Shake out the excess water, allow to dry, reassemble and store.

## TO REMOVE THE INTERNAL ASSEMBLY:

1. Remove the four screws. (Ref. No. 11). Remove the handle cover.
2. Unhook the trigger spring (Ref No. 7) from the spring pin (Ref. No. 6).
3. Using a small, thin-bladed screwdriver, pry the internal assembly sleeve (Ref. No. 5) out of the gun's valve chamber.
4. Slide the internal assembly (Ref. No. 8) out of the gun and, at the same time, lift the trigger assembly (Ref.No. 10) off the trigger pin (Ref. No. 9).
5. Unhook the trigger spring from the hole in the trigger assembly and slide the trigger assembly out of the square opening in the end of the internal assembly
6. Using a pair of pliers, pull the spring pin (Ref. No. 6) and the trigger pin (Ref. No. 9) out of the gun body
7. Inspect all of the parts and replace any that are worn or broken.

## TO REPLACE THE INTERNAL ASSEMBLY:

1. Press the spring pin (Ref. No. 6) and the trigger pin (Ref. No. 9) into the gun body. **NOTE: Make certain that the pin slots face each other.**
2. Slide the end of the trigger assembly (Ref. No. 10) into the square opening in the end of the internal assembly (Ref. No. 8).
3. Hook the trigger spring (Ref. No. 7) into the hole in the end of the trigger assembly. The open end of the spring should point down.
4. Slide the internal assembly into the gun's valve chamber and, at the same time, fit the hole in the trigger assembly over the trigger pin.
5. Push the sleeve of the internal assembly into the gun's valve chamber until the flange hits the stop.
6. Hook the trigger spring over the spring pin.
7. Replace the handle cover and install the four screws (Ref. No. 11).

## TO REPLACE THE VALVE SEAT:

1. To remove and replace the valve seat you must have the set of two special valve seat tools, LESCO No. 007455.
2. Follow the procedure on the previous page and remove the internal assembly from the gun.
3. Remove the hose fitting from the back of the gun.
4. Place the slotted end of the valve seat removal tool (the "U" shaped tool) into the hole in the valve seat

- (Ref. No. 3) until the tines snap into place.
5. Pull on the end of the tool until you can see the valve seat O-ring through the opening on the back of the gun.
6. Insert a common screwdriver into the back of the

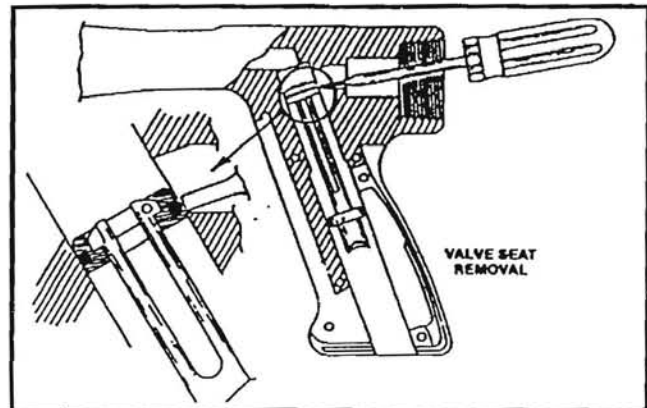

- gun and push against the O-ring while pulling on the end of the valve seat removal tool.
7. Remove the valve seat from the gun and dispose of it.
8. Lubricate the O-ring on the new valve seat and using your fingers, slip the valve seat part way into the gun's valve chamber.

**IMPORTANT: MAKE CERTAIN THAT THE RECESS OR COUNTERBORE IN THE VALVE SEAT POINTS INTO THE GUN'S VALVE CHAMBER.**

9. Insert the round end of the valve seat removal tool into the opening in the back of the gun. Make certain that the raised mark on the slotted end of the tool is pointing up, away from the gun's handle. Hold the tool firmly in this position. (This closes off the opening so the O-ring is not damaged when the valve seat is pushed into the end of the gun's valve chamber.)
10. Using the 6-inch plastic rod, push the valve seat all the way into the gun's valve chamber. Remove the tools and reassemble the gun according to the instructions for replacing the internal assembly.

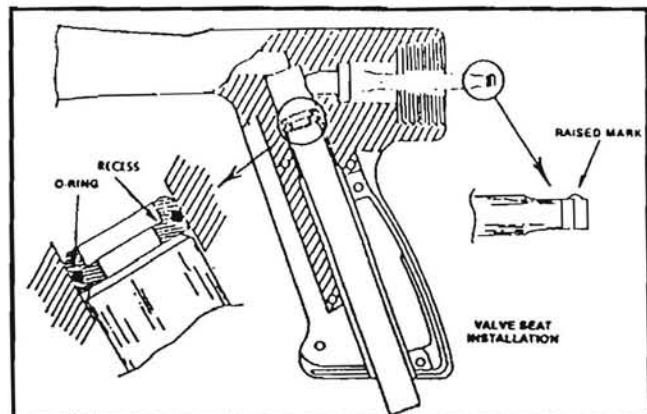

# TROUBLE-SHOOTING:

1. Trigger sticking open:
  - A. Broken trigger spring - replace spring.
  - B. Clogged with dry material - clean gun by soaking in clean water.
  - C. Rough bore in internal assembly sleeve - replace internal assembly.
2. Material leaking from nozzle:
  - A. Damaged valve - replace internal assembly.
  - B. Damaged valve seat - replace valve seat. (**NOTE:** The valve seat should not be replaced unless material will not stop flowing from the nozzle when the gun is shut off. Before removing the valve seat, first remove the internal assembly and inspect the plastic banded valve on its end for cuts or excessive wear. If the plastic banded valve shows no wear, then the valve seat should be replaced because it is probably damaged.)
3. Material leaking from handle:
  - A. Gun cracked - replace gun. (**NOTE:** Save all usable parts, i.e. spring, trigger assembly, pins, etc.)
  - B. O-Ring damaged - replace internal assembly and/or valve seat.
  - C. Internal assembly sleeve is not fully inserted into the gun's valve chamber. (A locking ridge on the handle cover will hold the sleeve in place if it has been pushed into the valve chamber until its flange hits the stop. If it is not fully inserted into the valve chamber, liquid pressure will blow the sleeve out of the chamber causing a flood of material flowing from the handle.)

## PARTS LIST

2" Extension 018107

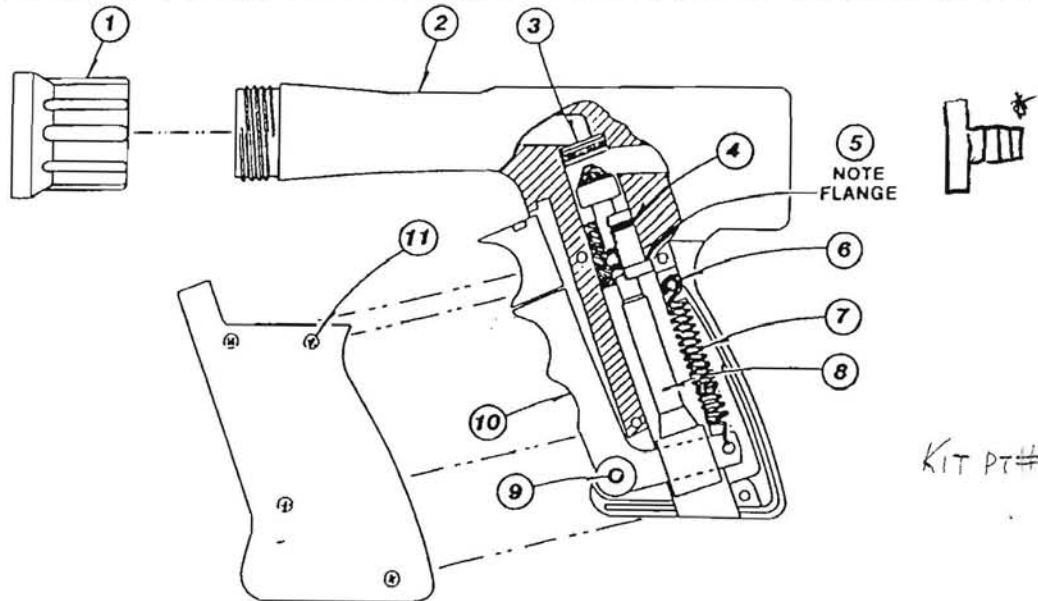

KIT PT#007642

REF. NO.	LESCO NO.	DESCRIPTION	NO. USED
1	018104	Nozzle, 1.5 GPM (Blue) .....	1
1	009510	Nozzle, 2 GPM (Yellow) .....	1
1	007668	Nozzle, 3 GPM (Green) .....	1
1	007655	Nozzle, 4 GPM (White) .....	1
2	018019	LESCO Gun with Blue Nozzle .....	1
3	007309	Valve Seat with O-Ring .....	1
4	018111	Large O-Ring .....	1
5	018112	Sleeve .....	1
6	*	Pin, Trigger Spring .....	1
7	018109	Trigger Spring .....	1
8	007642	Internal Assembly (Includes the Valve Stem Assembly and 1 ea. Ref. 4,5,6,7,9 and 4 ea. Ref. 11.) .....	1
9	*	Trigger Pin .....	1
10	007694	Trigger Assembly with Lock .....	1
11	018110	Screw .....	4
	007455	Valve Seat Tools — Set of Two (not shown) .....	1
	* 007681	Hose Fitting, 3/4"-MPT x 1/2"-Hose Barb, Nylon (not shown) .....	1

\* Included in Ref. No. 8, LESCO No. 007642, Internal Assembly.

018103 - Orifice .098