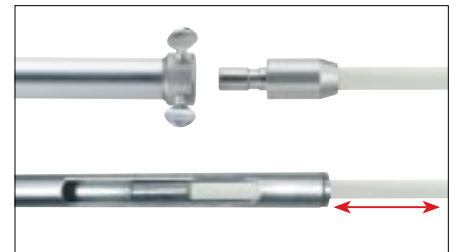

**WHIPPING POLES**

Choose between two lightweight, durable whipping pole models for removing dew and worm casts from greens.

- Each whipping pole offers two-piece design, with a lightweight anodized aluminum handle.
- Each whipping pole has a durable, 8 ft. (2.4 m) tapered fiberglass tip.
- On our original whipping pole, the handle and fiberglass tip are secured together by two thumb screws.
- On our E-Z Whip™ design, the fiberglass tip slides inside the handle during storage and transportation and easily extends out for whipping.

**E-Z WHIP WHIPPING POLE****1060** Best Seller**E-Z WHIP WHIPPING POLE PARTS (Not shown)****1065** Fiberglass Tip**1066** Handle with Hand Grip**ORIGINAL WHIPPING POLE****1040****ORIGINAL WHIPPING POLE PARTS (Not shown)****1045** Fiberglass Tip (Includes coupler)**1046** Handle with Hand Grip

Fiberglass tip slides in and out of handle (cut-away view)

[View product demo at ParAide.com](#)

**GREEN-SAVER BALL MARK REPAIR TOOL**

Keep your greens in shape with this durable, easy-to-use tool. Our Green-Saver quickly repairs ball marks with one simple step. It uses an eight-prong design that moves from the outside of the ball mark to the inside. A simple press of the handle sends the first set of four prongs into action. Then the second set enters the turf at an angle and closes the turf around the ball mark. The base acts like a tamp to flatten the newly repaired area, leaving a smooth putting surface.

Features include:

- Stainless steel parts.
- Self-lubricating bushing.
- Precision laser-cut components.
- Removable tabs on housing that allow for easy cleaning by flushing with water.

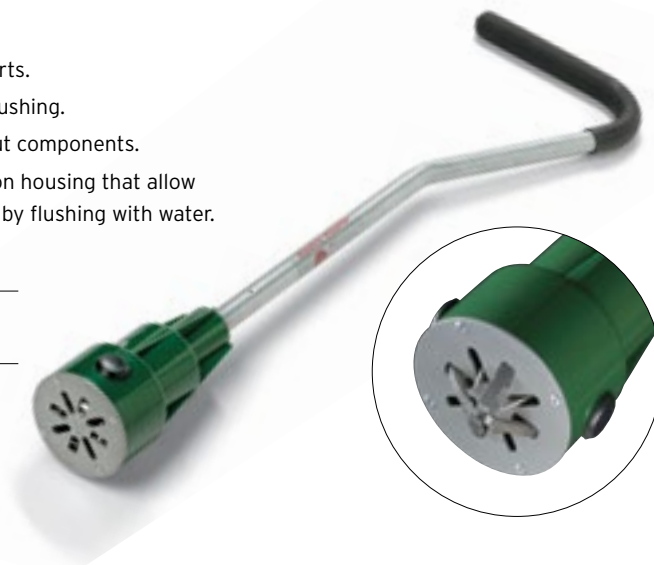
**GREEN-SAVER****1090**

[View product demo at ParAide.com](#)